



SPINNING REEL

DYNASPIN

SH5000 / SH6000

GEAR RATIO (4.4/3.3)

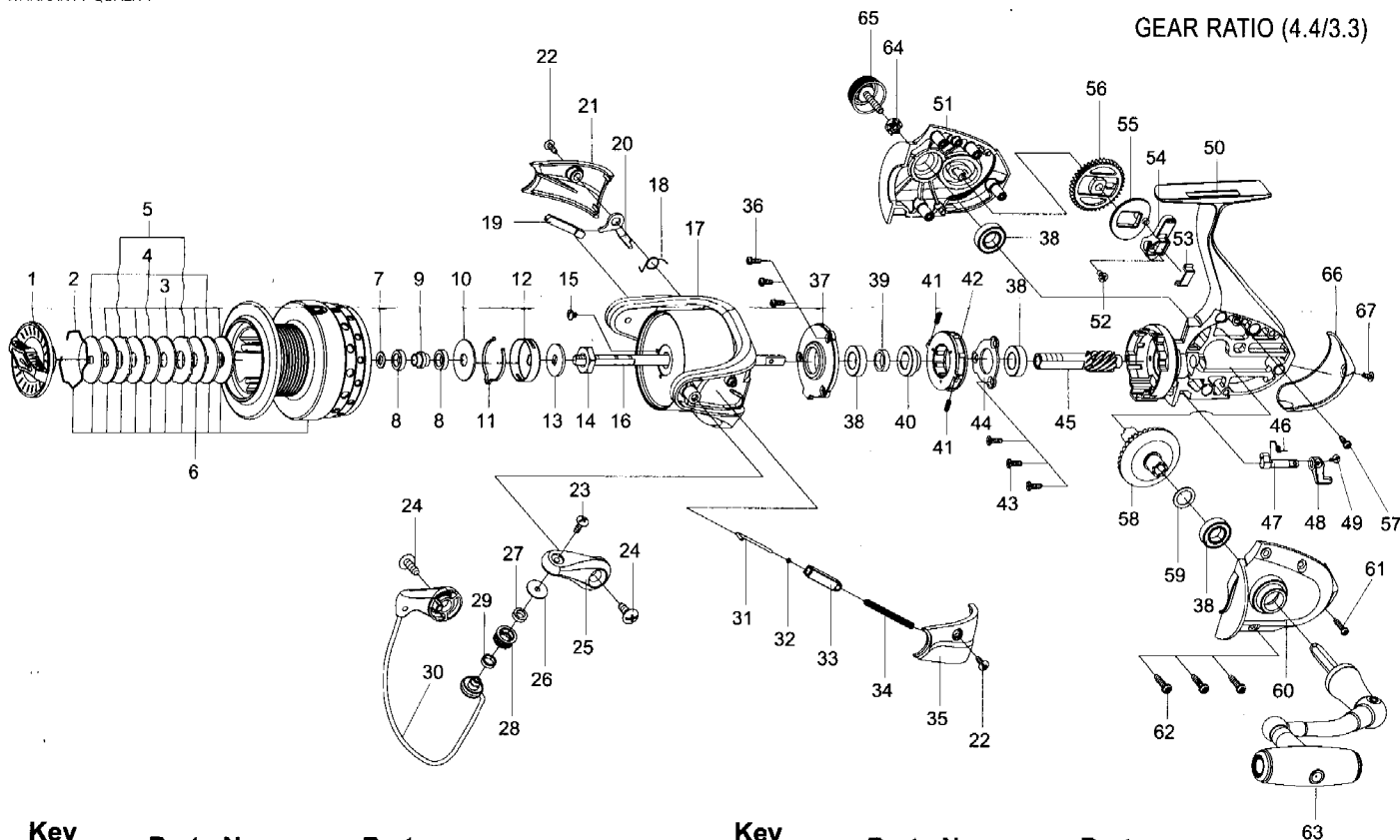

Key NO.	Parts No.	Parts name	Key NO.	Parts No.	Parts name
1	2YD-097-05	DRAG KNOB ASSEMBLY	37	2F8-124-01	BEARING HOLDER
2	2E4-034-01	DRAG WASHER RETAINER	38	2Z1-035-05	917-5 BALL BEARING
3	2W1-090-02	082-260 WASHER	39	2C1-126-01	COLLAR
4	2W2-061-01	KEY WASHER	40	2A4-019-05	ONE-WAY CLUTCH INNER TUBE
5	2W3-031-01	EARED WASHER	41	2Q1-071-01	CAGE SPRING
6	2YT-417-05	SPOOL TOTAL ASSEMBLY	42	2YZ-020-01	ONE-WAY CLUTCH BEARING ASSEMBLY
7	2W2-081-01	KEY WASHER	43	2E2-052-02	F26M-080 SCREW
8	2Z1-009-05	711-3 BALL BEARING	44	2F5-259-01	BEARING RETAINER
9	2C1-121-01	SPACER	45	2G2-162-01	PINION GEAR
10	2W1-237-01	070-225 WASHER	46	2Q3-009-01	ANTI-REVERSE SPRING
11	2L3-015-01	CLICK LEAF SPRING	47	2A2-075-01	ANTI-REVERSE CAM
12	2F8-019-01	CLICK LEAF SPRING HOLDER	48	2A1-034-05	ANTI-REVERSE LEVER
13	2W2-019-01	KEY WASHER	49	2E2-013-02	B20M-060 SCREW
14	2E3-003-01	ROTOR NUT	50	2YB-244-04	BODY ASSEMBLY
15	2E1-036-01	B26-040 SCREW	51	2B2-123-04	BODY COVER (R)
16	2M3-149-01	MAIN SHAFT	52	2E2-014-01	F26M-060 SCREW
17	2R1-143-04	ROTOR	53	2E5-062-01	OSCILLATING SILDER RETAINER
18	2Q3-108-01	BAIL SPRING	54	2M1-073-01	OSCILLATING SILDER
19	2R5-178-01	BAIL PAWL	55	2M2-015-01	OSCILLATING CAM
20	2R5-172-01	BAIL TRIP LEVER	56	2G3-093-01	OSCILLATING GEAR
21	2R4-197-01	BAIL TRIP COVER	57	2E1-045-01	A26-080 SCREW
22	2E1-016-02	B26-080 SCREW	58	2G1-152-01	DRIVE GEAR
23	2E2-007-01	B30M-100 SCREW	59	2W1-014-01	091-130 WASHER
24	2E1-072-01	B40-120 SCREW	60	2B2-122-04	BODY COVER (L)
25	2R2-067-04	BAIL ARM	61	2E1-005-02	A26-120 SCREW
26	2C1-049-01	LINE ROLLER COLLAR	62	2E1-006-02	A30-130 SCREW
27	2Z1-001-05	508-2.5 BALL BEARING	63	2YH-388-01	HANDLE TOTAL ASSEMBLY
28	2R6-018-02	LINE ROLLER	64	2C3-047-01	HANDLE SCREW SLEEVE
29	2C1-068-01	COLLAR	65	2H6-021-01	HANDLE SCREW CAP
30	2YL-154-05	BAIL ASSEMBLY	66	2F5-430-04	REAR COVER
31	2R5-186-01	BAIL TRIP SHAFT	67	2E2-055-01	B23M-050 SCREW
32	2W1-199-01	015-027 WASHER			
33	2C2-127-01	BAIL SPRING GUIDE	SH6000	SPECIAL PARTS	
34	2Q1-127-01	BAIL SPRING	6	2YT-418-05	SPOOL TOTAL ASSEMBLY
35	2R4-196-01	BAIL SPRING COVER	GEAR RATIO 3.3	SPECIAL PARTS	
36	2E2-037-01	A26M-060 SCREW	45	2G2-171-01	PINION GEAR
			58	2G1-154-01	DRIVE GEAR